

Township N°6 North, Range N°17 East, Mount Diablo Meridian.

M. E. M.
A.K.
J. B. S. J.

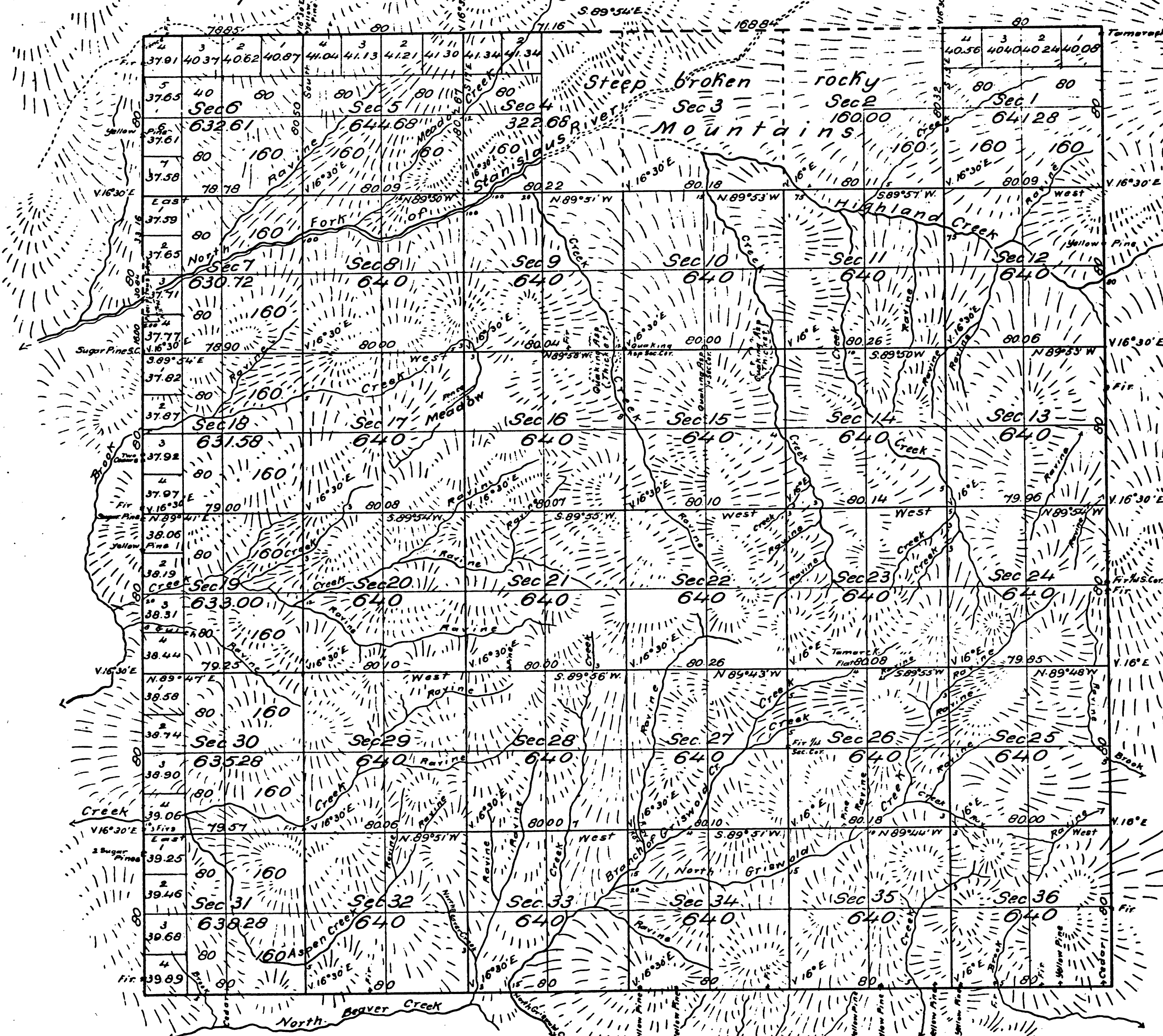

Aggregate Area of Public Land surveyed	21,570.21 Acres
Estimated Area of unsurveyed Mountain land	1,450.00 "
Aggregate	23,020.21 "

DEPARTMENT OF THE INTERIOR,
GENERAL LAND OFFICE,
Washington, D. C. *Sept 25 1907*
I hereby certify that this is a true copy
of the plat of official survey of the lands
to which it relates, on file in this office.

T. H. Thompson
Recorder, General Land Office.

Surveys Designated	By whom surveyed	Date of Contract	Amts of Surveys	When surveyed
Township lines	J. A. Benson & K. G. Over	July 15 th 1874		1874
Section "	J. M. Anderson	November 14 th 1876	57 m ¹ 79c ¹ 62 1/2	Dec. 26 th 1876.

The above Map of Township N^o 6 North, Range No 17 East, Mount Diablo Meridian is strictly conformable to the field notes of the surveys thereof, on file in this Office which have been examined and approved.

Surveyor General's Office,
San Francisco, California,
July 31st 1877.

L. Hollins,

H. Collins,
Surr. Genl. Cal.

