

OWNER'S STATEMENT

The undersigned being all parties having any record title interest in the land within this division, hereby consent to the preparation and recordation of this map.

Jeanine Nadel
Jeanine Nadel, President Board of Directors
Near & Arnold's School of Performing Arts and Cultural
Education, Inc., a California Corporation. (S.P.A.C.E.)

ACKNOWLEDGEMENT

State of California
County of Mendocino SS

On 21/10/00 before me, Ann Thompson, a notary public in and for said County and State, residing therein, duly commissioned and sworn, personally appeared Jeanine Nadel (or proved to me on the basis of satisfactory evidence) to be the persons whose names are subscribed to the within instrument and acknowledged to me that they executed the same in their authorized capacities and that by their signatures on the instrument the persons or the entity upon behalf of which the persons acted, executed the instrument.

WITNESS my hand and official seal

Ann Thompson
Name
Ann Thompson
My commission expires Dec 2, 2003

Notary Public in and for the
County of Mendocino
State of California

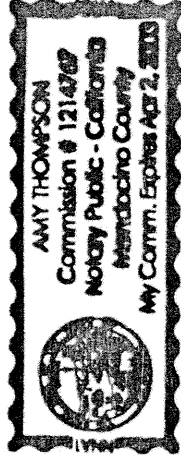

ACCURACY STATEMENT

I, Ron W. Franz, hereby state that all survey work required in the preparation of this map and related monumentation was performed to a minimum accuracy of 1:5000.

Ron W. Franz
Ron W. Franz L.S. 873

SURVEYOR'S STATEMENT

This map was prepared by me or under my direction and is based upon a field survey in accordance with the requirements of the Subdivision Map Act and local ordinance at the request of S.P.A.C.E. In September 1999, I hereby state that this Parcel Map substantially conforms to the approved, or conditionally approved, tentative map, if any. I further state that all monuments are of the character and occupy the positions indicated and that said monuments are sufficient to enable the survey to be retraced.

Ron W. Franz 1-20-00
Ron W. Franz L.S. 873
My license expires 12-31-03



PROOF OF OWNERSHIP STATEMENT

I hereby state that the proof of ownership report made by First American Title Co. this 12 day of April, 2000, conforms to the provisions of the Subdivision Map Act.

Marsha Young Wharff, County Recorder
Mendocino County, State of California

By: Rita Bernard
Deputy

BOND STATEMENT

I, Kristi Furman, Clerk of the Board of Supervisors of the County of Mendocino, State of California, hereby state that the bond or deposit as required by the "Subdivision Map Act", Section 66464 of Title 7 of the Government Code, Division 2, has been filed.

Dated this 12th day of April, 2000.

Kristi Furman Clerk, Board of Supervisors

By: Rita Bernard Deputy
Susan S. Gorman, Deputy

COUNTY RECORDER'S STATEMENT

Filed this 12 day of April, 2000, at 11:50 AM in Maps,
Drawer 67, Page 28 M.C.R., at the request of Ukiah City Engineer

Marsha Young Wharff, County Recorder
Mendocino County, State of California

By: Rita Bernard Deputy Fee: 10.00

CITY ENGINEER'S STATEMENT

I, Michael Kacey, hereby state that I have examined and checked this Parcel Map and that the subdivision as shown is substantially the same as it appears on the tentative map and any approved alterations thereof and I further certify that said map is in conformance with Title 7, Division 2, Chapter 2, of the government code, State of California, and the Ukiah City code, and I am therefore satisfied that the map is technically correct.

In Witness whereof, I have hereunto set my hand and affixed my official seal at Ukiah, California, this 21 day of March, 2000.

By: Michael Kacey
Ukiah City Engineer 2003373

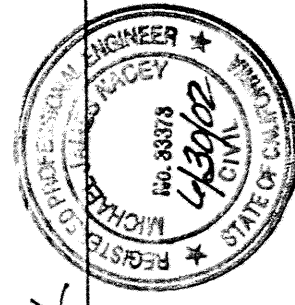

PARCEL MAP

OF MINOR SUBDIVISION 99-18

BEING BLOCK 48 OF THE

WESTERN ADDITION TO THE CITY OF UKIAH
as shown on said map prepared by S.H. Rice in 1888
and on file in the Map Drawers in the office of
the Recorder of Mendocino County

Mendocino County, California -- October 1999

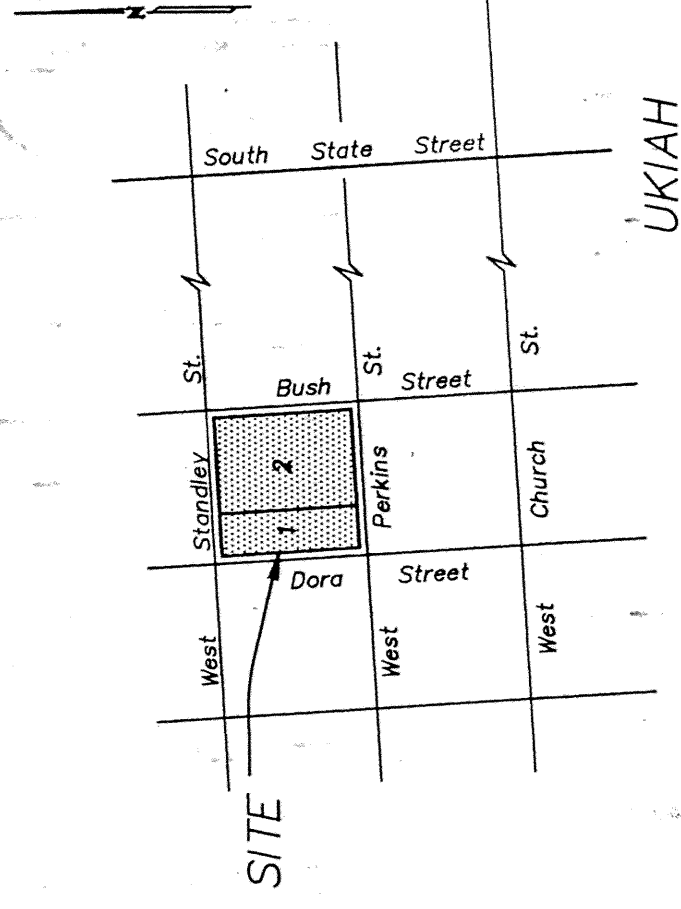

LOCATION MAP

NO SCALE

26

SHEET 1 OF 2 SHEETS

-- MAPS --

DRAWER 67

PAGE 29