

CORNER RECORD

Document Number CR 9793

City of OAKLAND

County of ALAMEDA, California

Brief Legal Description RAILROAD SPIKE MONUMENT LOCATED WITHIN 98TH AVENUE.

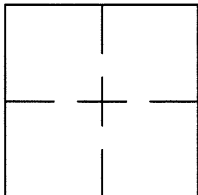

CORNER RECORD

Government Corner ☐ Control ☒
Meander ☐ Property ☐
Rancho ☐ Other ☐
Date of Survey 2/18/17

COORDINATES
(Optional)

N. _____
E. _____
Zone _____ Datum _____
Elev. _____

Corner — Left as found ☒ Found and tagged ☐ Established ☐ Reestablished ☐ Rebuilt ☐

Identification and type of corner found: Evidence used to identify or procedure used to establish or reestablish the corner:
FOUND RAILROAD SPIKE WITH PUNCH LOCATED WITHIN THE INTERSECTION OF
98TH AVENUE AND SUNNYSIDE STREET.

THIS POINT WAS REFERENCED PRIOR TO A CONSTRUCTION PROJECT IN THE VICINITY.

A description of the physical condition of the monument as found and as set or reset: _____
FOUND AND SET POINTS AS SHOWN ON PAGE 2.

THE TIES SHOWN HEREON ARE FOR THE PURPOSE OF PERPETUATING FOUND MONUMENTATION.

NO CLAIM IS MADE AS TO THE RELATIONSHIP OF THE POINTS OR LINES SHOWN HEREON TO
TRUE BOUNDARY LOCATIONS.

SURVEYOR'S STATEMENT

This Corner Record was prepared by me or under my direction in conformance with
the Land Surveyors' Act on MARCH 1, 2017.

Signed Scott V. Cunha L.S. Number LS 8525
SCOTT V. CUNHA

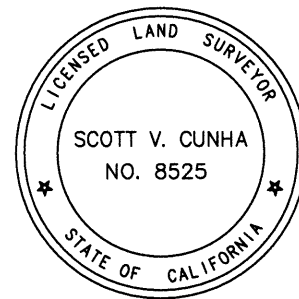

COUNTY SURVEYOR'S STATEMENT

This Corner Record was received 20 MARCH 2017 and examined
and filed 8 JUNE 2017.

Signed Michael Rubner Title COUNTY SURVEYOR

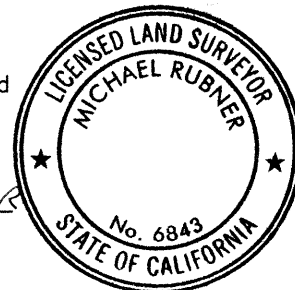

County Surveyor's Comment _____

SCALE: 1"=30'

LEGEND

- △ FOUND RAILROAD SPIKE WITH PUNCH
- SET CUT CROSS IN WALK
- ✕ SET CUT CROSS IN CURB
- ✕ SET MAG AND SHINER
- SET REBAR & CAP STAMPED "CEI RP"
- AA##A# ALAMEDA COUNTY MONUMENT ID
- 19592 REFERENCE STREET ADDRESS

