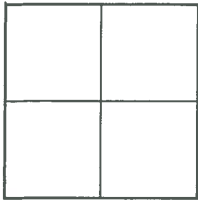

# CORNER RECORD

Agency Index

**CR743B**

Document Number

City of N/ACounty of NAPA, CaliforniaBrief Legal Description PORTION OF RECORD OF SURVEY, 18 RS 48, N.C.R.**CORNER TYPE**

Government Corner ☐ Control  
Meander ☐ Property  
Rancho ☐ Other

**COORDINATES (Optional)**

N. \_\_\_\_\_ E. \_\_\_\_\_

☒ Elevation \_\_\_\_\_Units Metric ☐ U.S. Survey Foot ☒☐ Horizontal Datum \_\_\_\_\_

Zone \_\_\_\_\_ Epoch Date \_\_\_\_\_

Vertical Datum \_\_\_\_\_

Date of Survey JULY 18, 2022☐ Complies with Public Resources Code §§8801-8819☐ Complies with Public Resources Code §§8890-8902PLS Act Ref: ☐ 8765(d) ☒ 8771 ☐ 8773 ☐ Other:

Corner/  
Monument: ☒ Left as found ☐ Established ☐ Rebuilt ☐ Pre-Construction  
☐ Found and tagged ☐ Reestablished ☒ Referenced ☒ Post-Construction

Narrative of corner identified and monument as found, set, reset, replaced, or removed:

☐ See sheet #2 for description (s):

FOUND 5/8" REBAR WITH CAP "PLS 6088" PER PRE-CONSTRUCTION CORNER RECORD CR743A.

MONUMENT WELL SET IN PLACE AROUND FOUND 1 1/2" BRASS DISC AT STATION 110+02.66 ALONG CENTERLINE OF AMERICAN CANYON ROAD, AS SHOWN ON RECORD OF SURVEY, FILED IN BOOK 18 OF SURVEYS, AT PAGE 48, NAPA COUNTY RECORDS.

**SURVEYOR'S STATEMENT**

This Corner Record was prepared by me or under my direction in conformance with the Professional Land Surveyors' Act on 8/3/2022

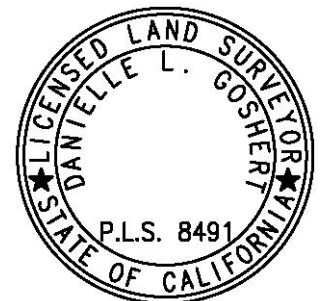
Signed [Signature] (P.L.S.) or R.C.E. No. 6608**COUNTY SURVEYOR'S STATEMENT**This Corner Record was received AUGUST 3, 2022and examined and filed AUGUST 4, 2022Signed [Signature] P.L.S. or R.C.E. No. 8491Title COUNTY SURVEYOR

County Surveyor's Comment \_\_\_\_\_

