

CORNER RECORD

Agency Index

BK 137 PG 50

Document Number

CR 14946

City of FREMONT

County of

ALAMEDA

, California

Brief Legal Description

MONUMENT LOCATED WITHIN MONTE SERENO TER AT 3132 MONTE SERENO TER
TRACT NO. 6726 AVALON - UNIT No. # 5 LOT 25 APN: 519-1720-26

CORNER TYPE

COORDINATES (Optional)

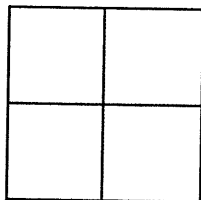

Government Corner

☐

Control

☒

Meander

☐

Property

☐

Rancho

☐

Other

☐

N.

E.

Elevation

Units

Metric ☐U.S. Survey Foot ☐

Horizontal Datum

Zone

Epoch Date

Vertical Datum

☐ Complies with Public Resources Code §§8801-8819☐ Complies with Public Resources Code §§8890-8902Date of Survey 10/23/2020

PLS Act Ref:

☐

8765 (d)

☒

8771

☐

8773

☐

Other:

Corner/
Monument:☐

Left as found

☐

Established

☒

Rebuilt

☐

Pre-Construction

☐

Found and tagged

☐

Reestablished

☐

Referenced

☒

Post-Construction

Narrative of corner identified and monument as found, set, reset, replaced, or removed:

☐ See sheet #2 for description (s): SEE REFERENCE CR 14841

SET 5/8" REBAR WITH 2" BRONZE CAP STAMPED "TOWILL RESET 2020 - PLS 8525"

FOUND AND SET POINTS AS SHOWN ON PAGE 2.

THIS POINT WAS INSTALLED AFTER A CONSTRUCTION PROJECT IN THE VICINITY.

THE TIES SHOWN HEREON ARE FOR THE PURPOSE OF PERPETUATING FOUND MONUMENTATION.
NO CLAIM IS MADE AS TO THE RELATIONSHIP OF THE POINTS OR LINES SHOWN HEREON TO TRUE
BOUNDARY LOCATION.

SURVEYOR'S STATEMENT

This Corner Record was prepared by me or under my direction in conformance with

the Professional Land Surveyors' Act on OCTOBER 28, 2020.

Signed

P.L.S. or R.C.E. No.

8525

SCOTT V. CUNHA

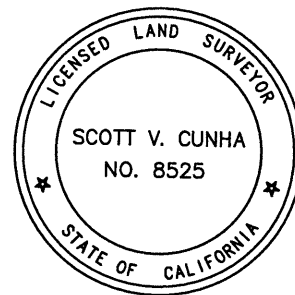

COUNTY SURVEYOR'S STATEMENT

This Corner Record was received _____,

and examined and filed FEB 23 2021.

Signed

P.L.S. or R.C.E. No.

7010

Title ALAMEDA COUNTY SURVEYOR

County Surveyor's Comment

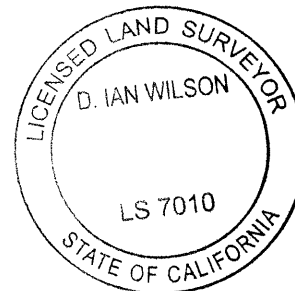

SCALE: 1"=30'

LEGEND

⊙ SET 5/8" REBAR WITH 2" BRONZE CAP STAMPED
"TOWILL RESET 2020 - PLS 8525"

✕ FOUND NAIL AND TAG IN CURB STAMPED "TOWILL RP"

(9592) REFERENCE STREET ADDRESS

ALL MEASUREMENTS ARE IN U.S. SURVEY FOOT AND DECIMAL FRACTION THEREOF

