

MICROFILM

DATE 10/10/80 BY 100-100

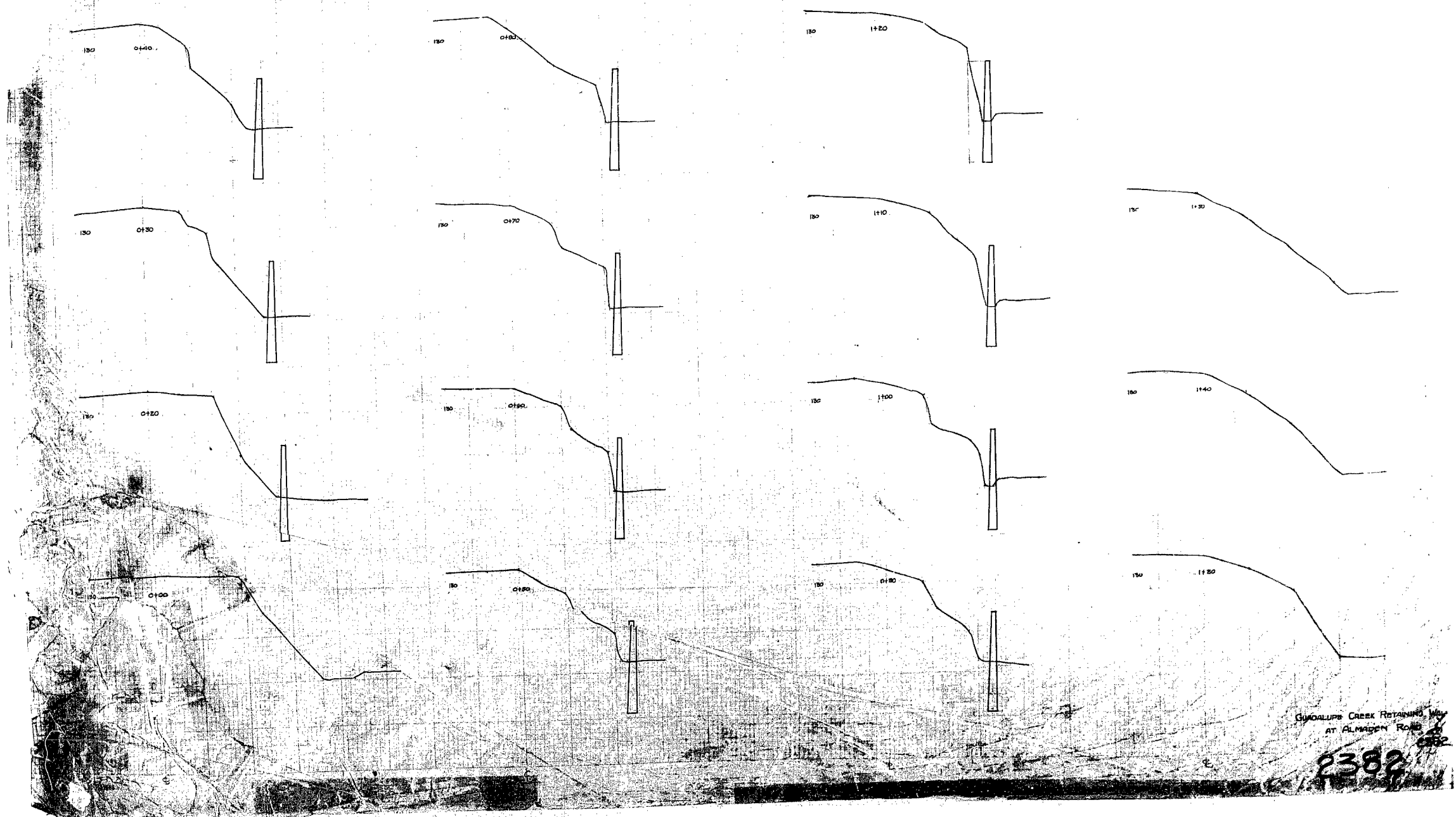

QUADALUPE CREEK RETAINING WALL
AT ALMADEN ROAD

2382

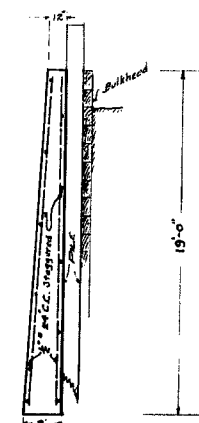
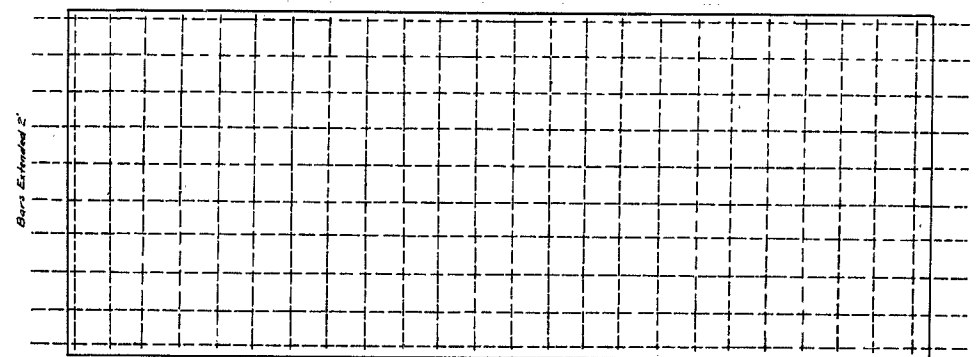
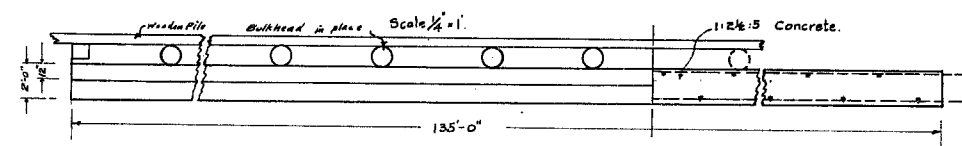
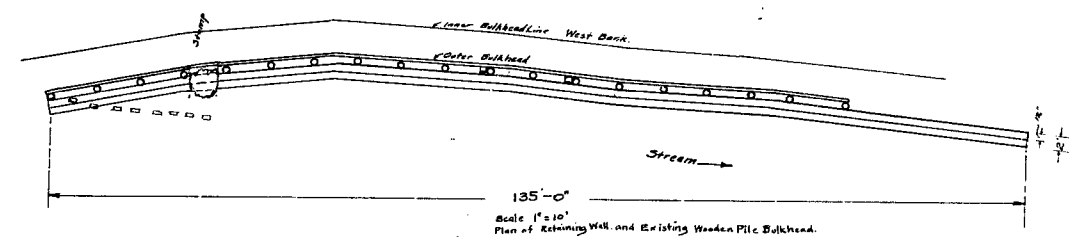
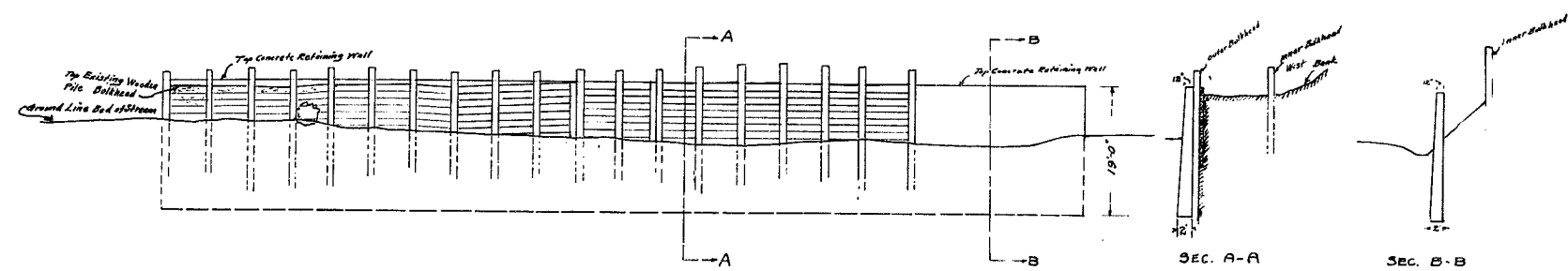

Reinforced Concrete Retaining Wall on
Guadalupe Creek, at ARATA'S PLACE.

2382

MICROFILM

PLANS
 FOR
 REINFORCED CONCRETE RETAINING WALLS
 ON
 GUADALUPE CREEK
 AT
 ALMADEN ROAD AND MT. ARATA'S PLACE
 IN
 SUPERVISOR DISTRICT N^o 4

AUGUST 1923.

R.B. CHANDLER - CO. SURVEYOR.

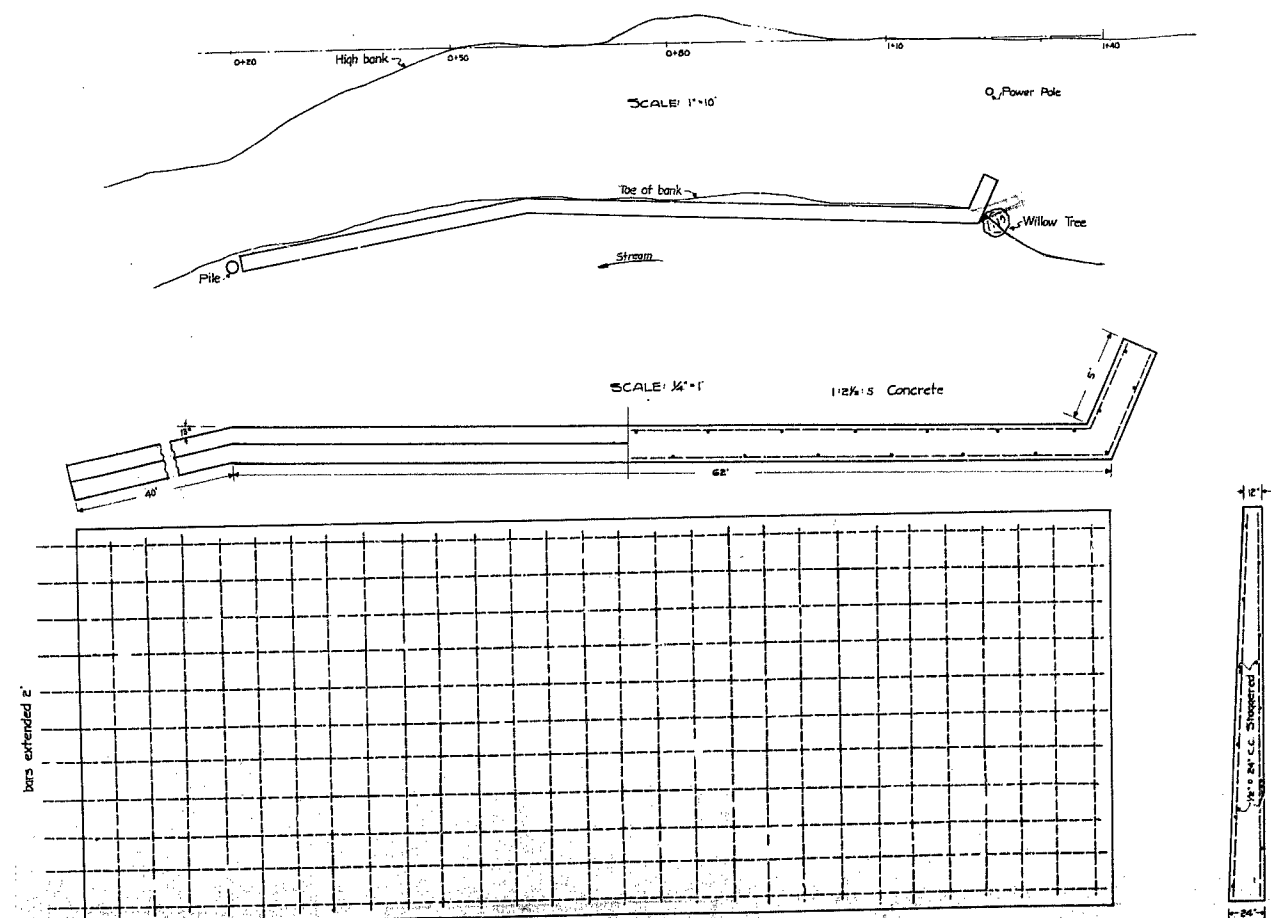

2382

MICROFILM

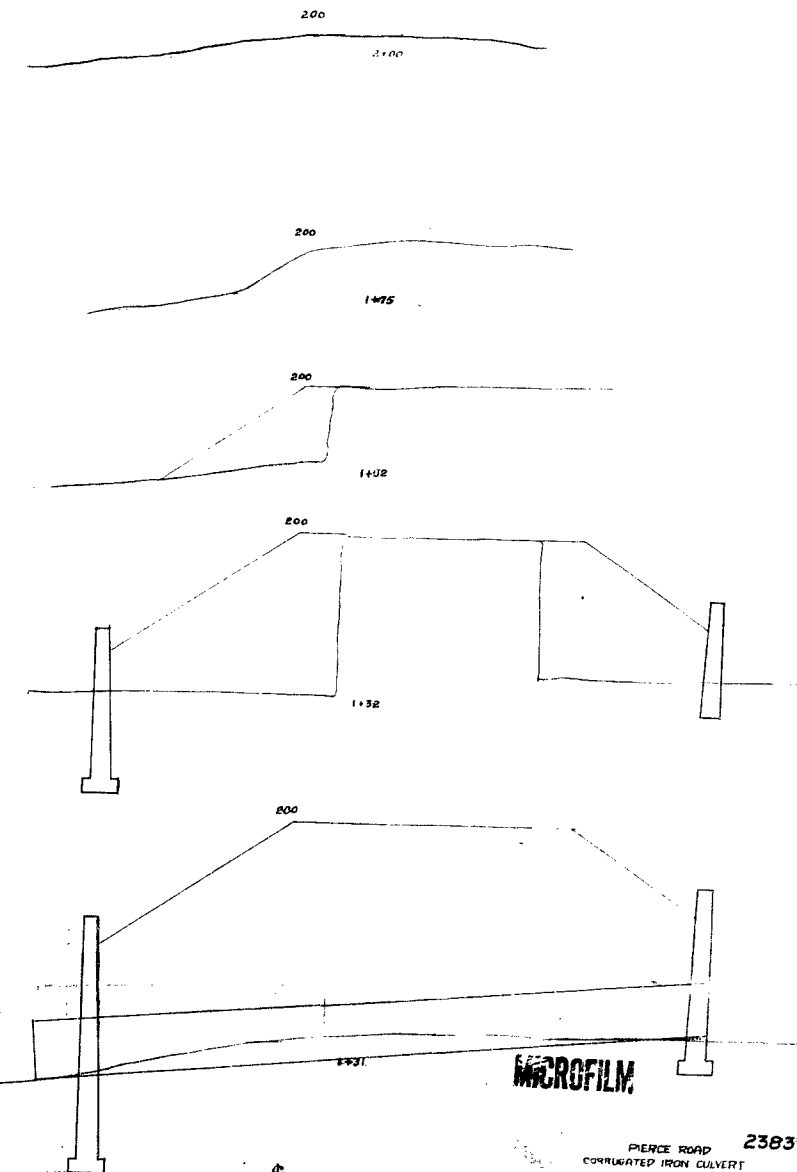
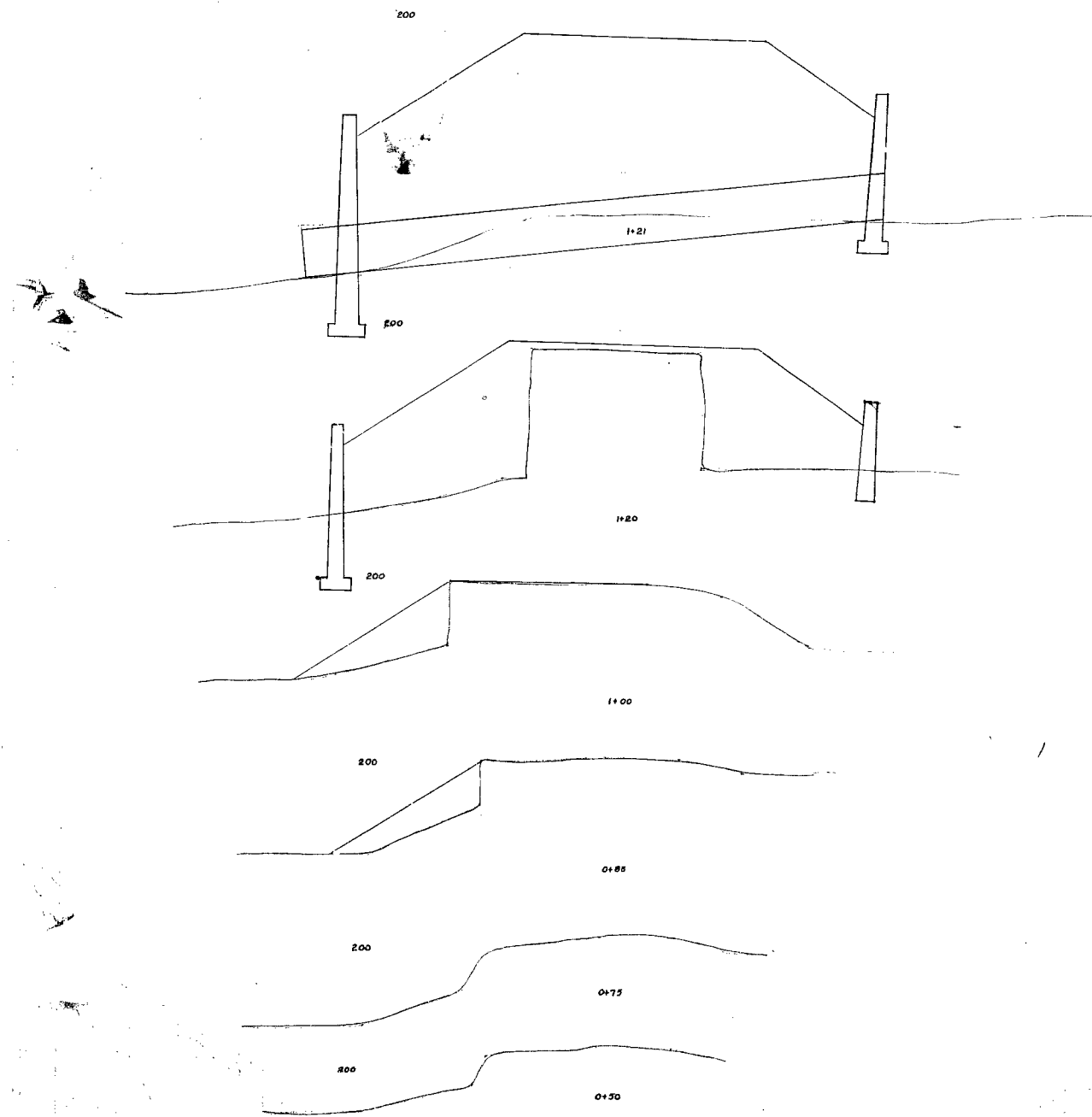

MICROFILM

PIERCE ROAD
CORRUGATED IRON CULVERT

2383

MICROFILM

PLANS
FOR
CORRUGATED IRON CULVERT
ON
PIERCE ROAD
IN
SUPERVISOR DISTRICT N°5

Aug. 1923

R.B. Chandler
Co. Surveyor

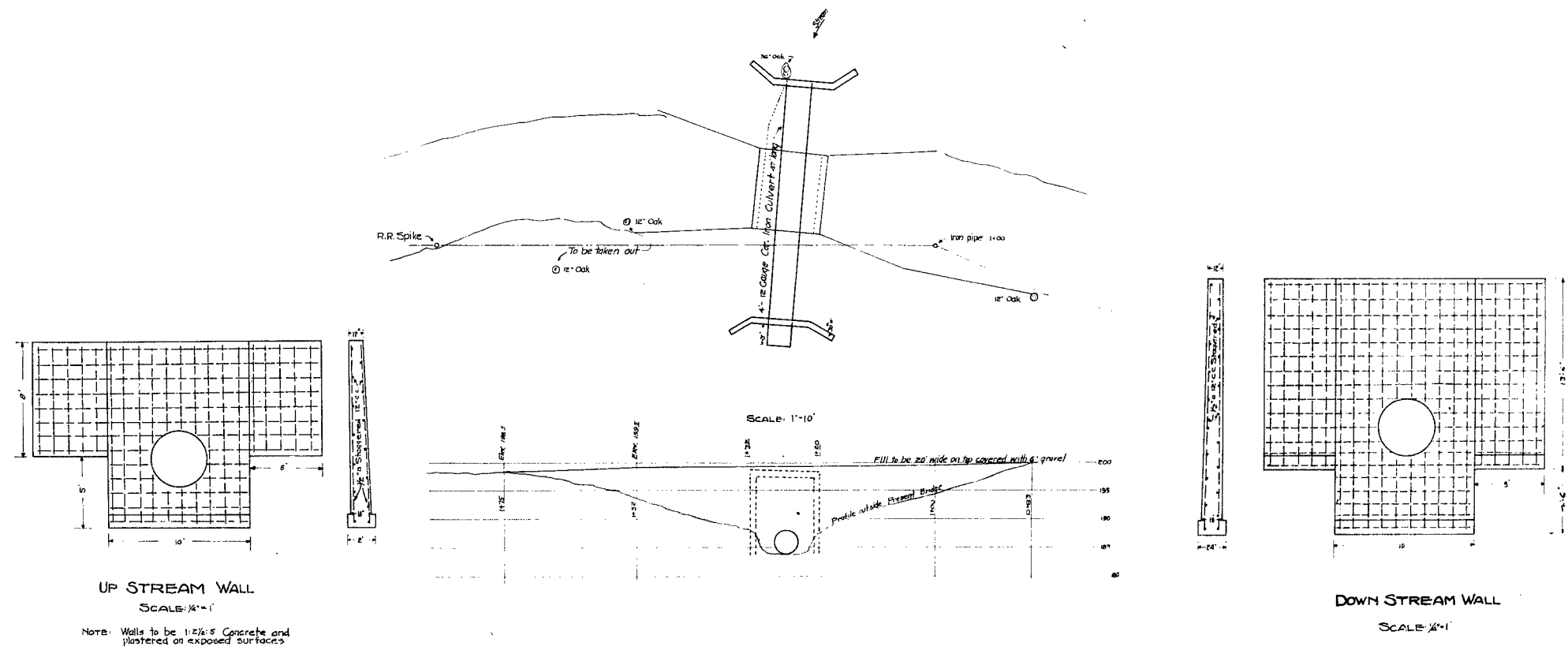

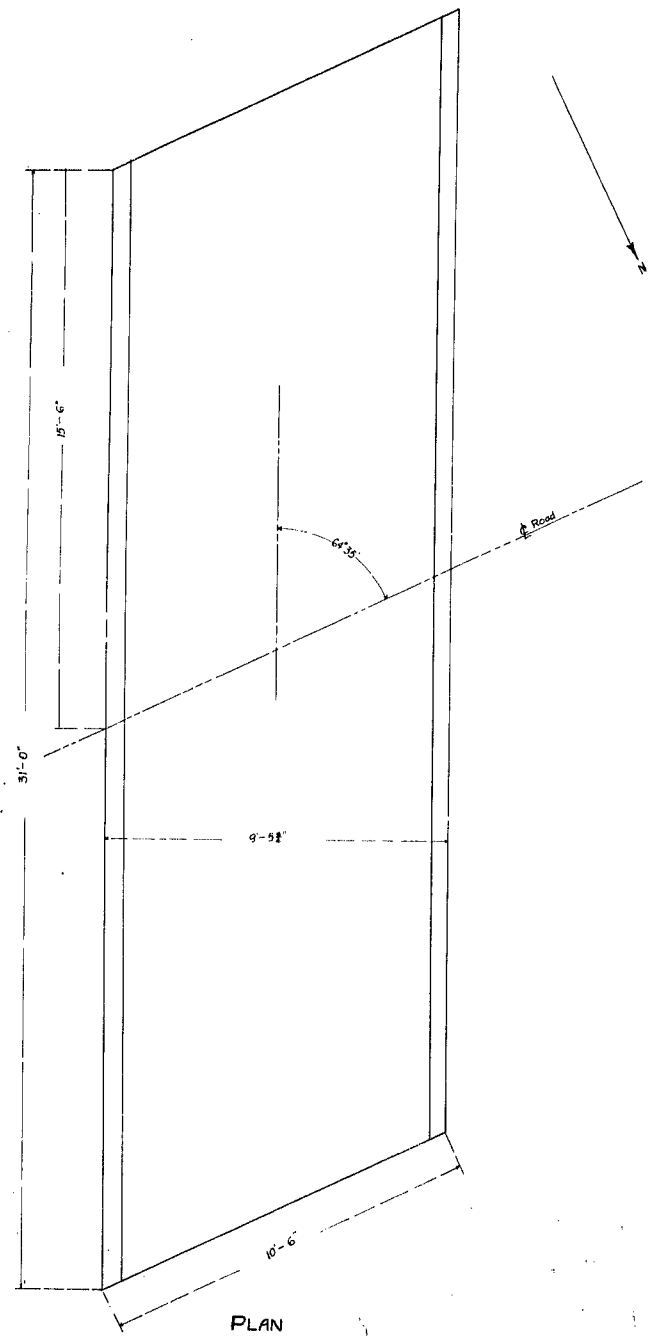

PLAN
For
REINFORCED CONCRETE CULVERT.
For
SANTA CLARA VALLEY WATER COMPANY.
Scale: 1/4" = 1'-0"

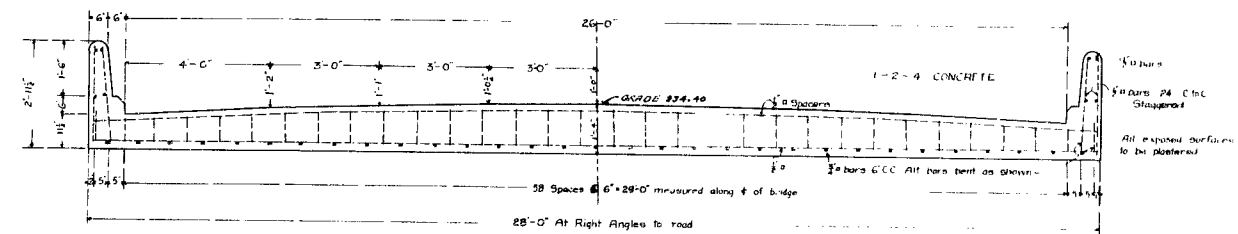

SECTION AT RT. ANGLES TO E

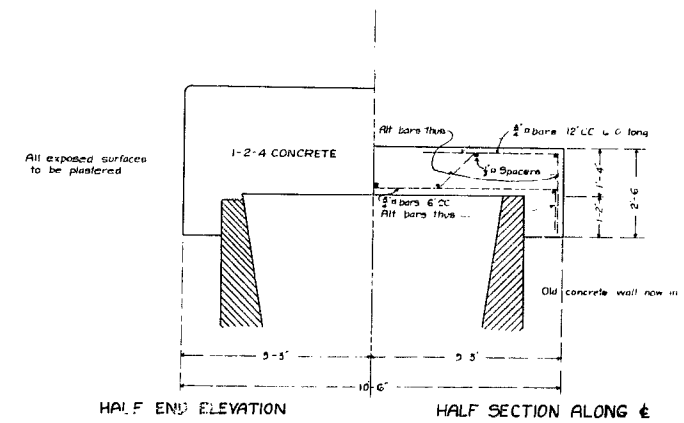

MICROFILM